

Nipple

Straight hose connection

Series 710: Nipple for SAE 100R1/R2 hose or equivalent

Working Pressure
 1/4" 350 bar (5076 PSI)
 3/8" 350 bar (5076 PSI)
 1/2" 350 bar (5076 PSI)
 3/4" 350 bar (5076 PSI)
 1" 250 bar (3625 PSI)

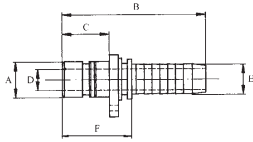

	Part No.	Connection (E)	A	B	C	D	F	
NIPPLE - straight	Series 710, 1/4"	14 710 0403	3/16" (5.25)	10.0	54.5	19.0	2.8	29.2
		14 710 0404	1/4" (6.9)	10.0	58.0	19.0	4.5	30.0
	Series 710, 3/8"	14 710 0604	1/4" (6.9)	13.0	61.0	22.0	4.5	33.0
		14 710 0605	5/16" (8.6)	13.0	61.0	22.0	5.6	33.0
	Series 710, 1/2"	14 710 0806	3/8" (10.1)	13.0	63.0	22.0	7.0	33.0
		14 710 0808	1/2" (13.6)	16.0	64.0	22.0	9.5	33.0
	Series 710, 3/4"	14 710 1208	1/2" (13.6)	23.0	73.5	31.0	9.5	42.5
		14 710 1210	5/8" (16.8)	23.0	77.5	31.0	13.0	43.3
		14 710 1212	3/4" (20)	23.0	82.0	31.0	15.0	43.0
	Series 710, 1"	14 710 1616	1" (26.2)	30.0	100.5	38.5	21.0	54.0

Nipple

90° Hose connection

Series 714: Nipple for SAE 100R1/R2 hose or equivalent

Working Pressure
 1/4" 350 bar (5076 PSI)
 3/8" 350 bar (5076 PSI)
 1/2" 350 bar (5076 PSI)
 3/4" 350 bar (5076 PSI)

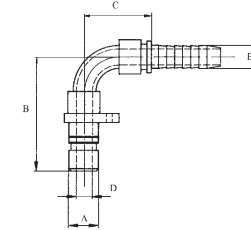

	Part No.	Connection (E)	A	B	C	D	
NIPPLE - 90°	Series 714, 1/4"	14 714 0404	1/4" (6.9)	10.0	51.0	34.0	4.5
	Series 714, 3/8"	14 714 0606	3/8" (10.1)	13.0	60.0	39.0	7.0
	Series 714, 1/2"	14 714 0806	3/8" (10.1)	16.0	61.0	39.0	7.0
		14 714 0808	1/2" (13.6)	16.0	69.0	48.0	9.0
	Series 714, 3/4"	14 714 1212	3/4" (20)	23.0	104.5	75.0	14.5

Nipple

45° Hose connection

Series 712: Nipple for SAE 100R1/R2 hose or equivalent

Working Pressure
 1/4" 350 bar (5076 PSI)
 3/8" 350 bar (5076 PSI)
 1/2" 350 bar (5076 PSI)
 3/4" 350 bar (5076 PSI)

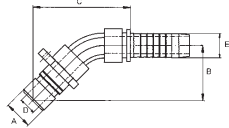

	Part No.	Connection (E)	A	B	C	D	
NIPPLE - 45°	Series 712, 1/4"	14 712 0404	1/4" (6.9)	10.0	28.0	51.0	4.5
	Series 712, 3/8"	14 712 0606	3/8" (10.1)	13.0	33.0	59.0	7.0
	Series 712, 1/2"	14 712 0808	1/2" (13.6)	16.0	36.0	66.0	9.0

Nipple

Stop

Working Pressure
 1/4" 350 bar (5076 PSI)
 3/8" 350 bar (5076 PSI)
 1/2" 350 bar (5076 PSI)
 3/4" 350 bar (5076 PSI)
 1" 250 bar (3625 PSI)

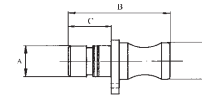

	Part No.	A	B	C	E	
NIPPLE - Stop	Series 723, 1/4"	14 723 0400	10.0	43.0	19.0	12.0
	Series 723, 3/8"	14 723 0600	13.0	50.0	22.0	16.0
	Series 723, 1/2"	14 723 0800	16.0	50.0	22.0	19.0
	Series 723, 3/4"	14 723 1200	23.0	59.0	31.0	25.0
	Series 723, 1"	14 723 1600	30.0	75.0	38.5	33.0

Coupling

External G-Thread (ISO 228/1)

Working Pressure

- 1/4" 350 bar (5076 PSI)
- 3/8" 350 bar (5076 PSI)
- 1/2" 350 bar (5076 PSI)
- 3/4" 350 bar (5076 PSI)
- 1" 250 bar (3625 PSI)

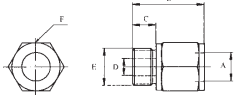

COUPLING – G-Thread	Part No.	Connection (E)	A	B	C	D	F (hexagon)	
	Series 810, 1/4"	14 810 0404	G 1/4"	10.0	38.4	12.0	4.5	20
	Series 810, 3/8"	14 810 0606	G 3/8"	13.0	41.9	12.0	7.0	24
	Series 810, 1/2"	14 810 0808	G 1/2"	16.0	43.5	14.0	9.5	28
	Series 810, 3/4"	14 810 1212	G 3/4"	23.0	56.0	16.0	15.0	36
	Series 810, 1"	14 810 1616	G 1"	30.0	67.0	18.0	21.0	41

Coupling

Stop

Working Pressure

- 1/4" 350 bar (5076 PSI)
- 3/8" 350 bar (5076 PSI)
- 1/2" 350 bar (5076 PSI)
- 3/4" 350 bar (5076 PSI)
- 1" 250 bar (3625 PSI)

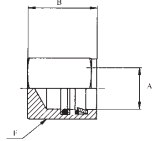

COUPLING – Stop	Part No.	A	B	F (hexagon)	
	Series 811, 1/4"	14 811 0400	10.0	29.4	20
	Series 811, 3/8"	14 811 0600	13.0	31.3	24
	Series 811, 1/2"	14 811 0800	16.0	32.3	28
	Series 811, 3/4"	14 811 1200	23.0	44.0	32
	Series 811, 1"	14 811 1600	30.0	55.0	41

Coupling

Straight hose connection

Series 817: Coupling for SAE 100R1/R2 hose or equivalent

Series 818: Coupling for SAE 100R9R multi-spiral hose

Working Pressure

- 1/4" 350 bar (5076 PSI)
- 3/8" 350 bar (5076 PSI)
- 1/2" 350 bar (5076 PSI)
- 3/4" 350 bar (5076 PSI)
- 1" 250 bar (3625 PSI)

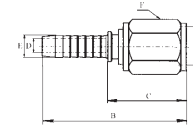

COUPLING – Straight	Part No.	Connection (E)	A	B	C	D	F (hexagon)	
	Series 817, 1/4"	14 817 0404	1/4" (6.9)	10.0	62.4	34.0	4.5	20
	Series 817, 3/8"	14 817 0606	3/8" (10.1)	13.0	66.9	36.0	7.0	24
	Series 817, 1/2"	14 817 0808	1/2" (13.6)	16.0	67.0	36.0	9.5	27
	Series 817, 3/4"	14 817 1212	3/4" (20)	23.0	87.0	48.0	15.0	32
	Series 817, 1"	14 817 1616	1" (26.2)	30.0	105.0	58.5	21.0	41
	Series 818, 3/4"	14 818 1212	3/4" (19.8)	23.0	95.0	49.0	15.0	32
	Series 818, 1"	14 818 1616	1" (26.2)	30.0	115.0	60.0	21.0	41

Coupling

SAE J514 O-Ring Boss

Working Pressure

- 1/4" 350 bar (5076 PSI)
- 3/8" 350 bar (5076 PSI)
- 1/2" 350 bar (5076 PSI)
- 3/4" 350 bar (5076 PSI)
- 1" 250 bar (3625 PSI)

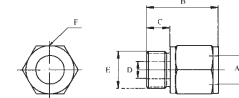

COUPLING – O-Ring Boss	Part No.	UNF/UN (E)	A	B	C	D	F (hexagon)	
	Series 826, 1/4"	14 826 0407	7/16"-20	10.0	35.4	9.0	4.5	20
	Series 826, 3/8"	14 826 0609	9/16"-18	13.0	39.9	10.0	7.0	24
	Series 826, 1/2"	14 826 0812	3/4"-16	16.0	40.5	11.0	9.5	28
		14 826 0814	7/8"-14	16.0	42.1	12.6	12.7	28
		14 826 0817	1 1/16"-12	16.0	44.5	15.0	14.5	28
	Series 826, 3/4"	14 826 1217	1 1/16"-12	23.0	55.0	15.0	15.0	32
	Series 826, 1"	14 826 1621	1 5/16"-12	30.0	64.0	15.0	21.0	41

Coupling

External G-Thread with Integral Rubber Seal

Working Pressure

1/4"	350 bar (5076 PSI)
3/8"	350 bar (5076 PSI)
1/2"	350 bar (5076 PSI)
3/4"	350 bar (5076 PSI)
1"	250 bar (3625 PSI)

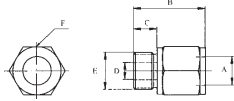

Rubber seals comply with DIN 3869

	Part No.	Connection (E)	A	B	C	D	F(hexagon)	
COUPLING - G-Thread	Series 830, 1/4"	14 830 0404	G 1/4"	10.0	38.0	12.0	4.5	20
	Series 830, 3/8"	14 830 0606	G 3/8"	13.0	41.0	12.0	7.0	24
	Series 830, 1/2"	14 830 0808	G 1/2"	16.0	43.0	14.0	9.5	28
	Series 830, 3/4"	14 830 1212	G 3/4"	23.0	56.0	16.0	15.0	36
	Series 830, 1"	14 830 1616	G 1"	30.0	69.0	18.0	21.0	41

Coupling

Metric (ISO 6149 – 3)

Working Pressure

14 831 0612	350 bar (5076 PSI)
14 831 0616	315 bar (4570 PSI)
14 831 0818	315 bar (4570 PSI)
14 831 1222	315 bar (4570 PSI)
14 831 1227	200 bar (2900 PSI)

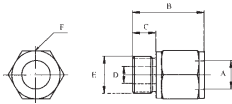

	Part No.	Connection (E)	A	B	C	D	F (hexagon)	
COUPLING - Metric	Series 831, 3/8"	14 831 0612	M12x1.5	13.0	40.9	11.0	6.0	24
		14 831 0616	M16x1.5	13.0	41.4	11.5	7.5	24
	Series 831, 1/2"	14 831 0818	M18x1.5	16.0	42.0	12.5	9.5	28
	Series 831, 3/4"	14 831 1222	M22x1.5	23.0	53.0	13.0	14.0	32
		14 831 1227	M27x2	23.0	56.0	16.0	15.0	32

Coupling

Bulkhead

Working Pressure

1/4"	350 bar (5076 PSI)
3/8"	350 bar (5076 PSI)
1/2"	350 bar (5076 PSI)

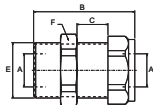

	Part No.	A	B	C	E	F (hexagon)	
COUPLING - Bulkhead	Series 813, 1/4"	14 813 0444	10.0	42.8	0-18	M21.5 x 1.5	22
	Series 813, 3/8"	14 813 0646	13.0	50.8	0-25	M26 x 1.5	27
	Series 813, 1/2"	14 813 0848	16.0	50.0	0-25	M30 x 2	32

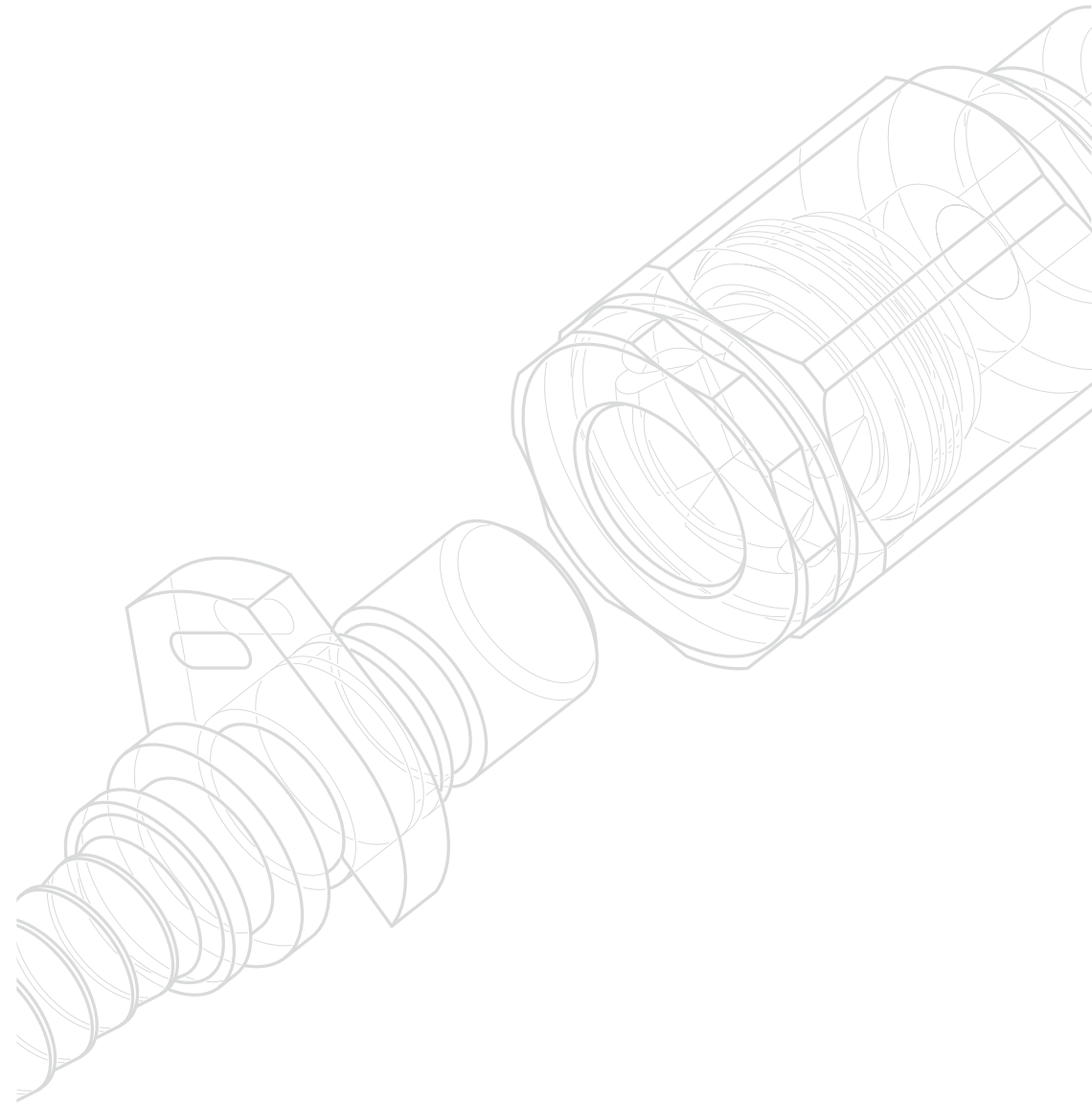

Other Products Available from CEJN

To obtain product information or product brochures, contact your nearest CEJN office or representative, or visit us on the Internet at www.cejn.com